



4-249.01DST DST Hinge 22x30 Pr01 180°



1DST1

Avantages

- Hinge with DIRAK-SNAP-Technology.
- For nested doors.
- Hinge visible.
- RH / LH application.
- 180° Opening angle.
- Tool-less installation.
- Seismic-proof according to GR-63-CORE, Issue 4.
- Installation by a simple push into the cutout.

Materials

- **Hinge-parts:** zinc die, matte chrome plated or black
- **Pin:** stainless steel
- **Snap wedges:** sintered steel, zinc plated

Notes

1. alternative cutout
2. indentation as a guideline for correct positional installation to avoid errors



Hinge, zinc die

Part Number	Clamping range (S)	Surface	Pin version	Installation type	Delivery Unit
418-9301.33-00008	0.6 - 0.9 mm	black	pressed in	tool-less	10 pcs.
418-9301.33-00010	0.8 - 1.1 mm	black	pressed in	tool-less	10 pcs.
418-9301.33-00014	1.2 - 1.5 mm	black	pressed in	tool-less	10 pcs.
418-9301.33-00020	1.8 - 2.1 mm	black	pressed in	tool-less	10 pcs.
418-9301.33-00024	2.2 - 2.5 mm	black	pressed in	tool-less	10 pcs.
418-9301.40-00008	0.6 - 0.9 mm	matte chrome plated	pressed in	tool-less	10 pcs.
418-9301.40-00010	0.8 - 1.1 mm	matte chrome plated	pressed in	tool-less	10 pcs.
418-9301.40-00014	1.2 - 1.5 mm	matte chrome plated	pressed in	tool-less	10 pcs.
418-9301.40-00020	1.8 - 2.1 mm	matte chrome plated	pressed in	tool-less	10 pcs.
418-9301.40-00024	2.2 - 2.5 mm	matte chrome plated	pressed in	tool-less	10 pcs.

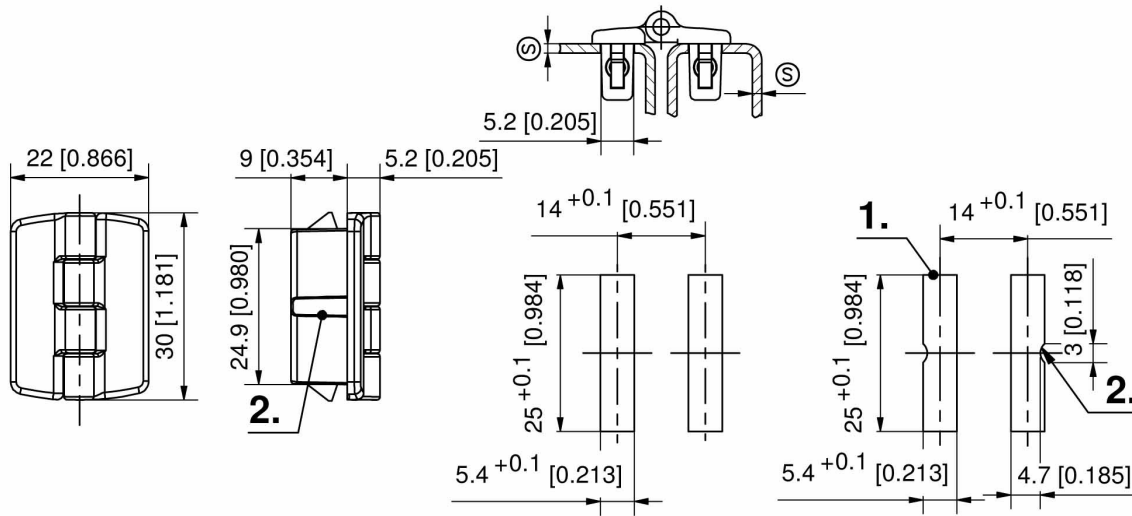



4-249.02DST DST Hinge 34x30 Pr01 180°



Avantages

- Hinge with DIRAK-SNAP-Technology.
- For nested doors.
- Hinge visible.
- RH / LH application.
- 180° Opening angle.
- Tool-less installation.
- Seismic-proof according to GR-63-CORE, Issue 4.
- Installation by a simple push into the cutout.

Materials

- **Hinge-parts:** zinc die, matte chrome plated or black
- **Pin:** stainless steel
- **Snap wedges:** sintered steel, zinc plated

Notes

1. alternative cutout
2. indentation as a guideline for correct positional installation to avoid errors



Hinge, zinc die

Part Number	Clamping range (S)	Surface	Pin version	Installation type	Delivery Unit
418-9302.33-00008	0.6 - 0.9 mm	black	pressed in	tool-less	10 pcs.
418-9302.33-00010	0.8 - 1.1 mm	black	pressed in	tool-less	10 pcs.
418-9302.33-00014	1.2 - 1.5 mm	black	pressed in	tool-less	10 pcs.
418-9302.33-00020	1.8 - 2.1 mm	black	pressed in	tool-less	10 pcs.
418-9302.33-00024	2.2 - 2.5 mm	black	pressed in	tool-less	10 pcs.
418-9302.40-00008	0.6 - 0.9 mm	matte chrome plated	pressed in	tool-less	10 pcs.
418-9302.40-00010	0.8 - 1.1 mm	matte chrome plated	pressed in	tool-less	10 pcs.
418-9302.40-00014	1.2 - 1.5 mm	matte chrome plated	pressed in	tool-less	10 pcs.
418-9302.40-00020	1.8 - 2.1 mm	matte chrome plated	pressed in	tool-less	10 pcs.
418-9302.40-00024	2.2 - 2.5 mm	matte chrome plated	pressed in	tool-less	10 pcs.

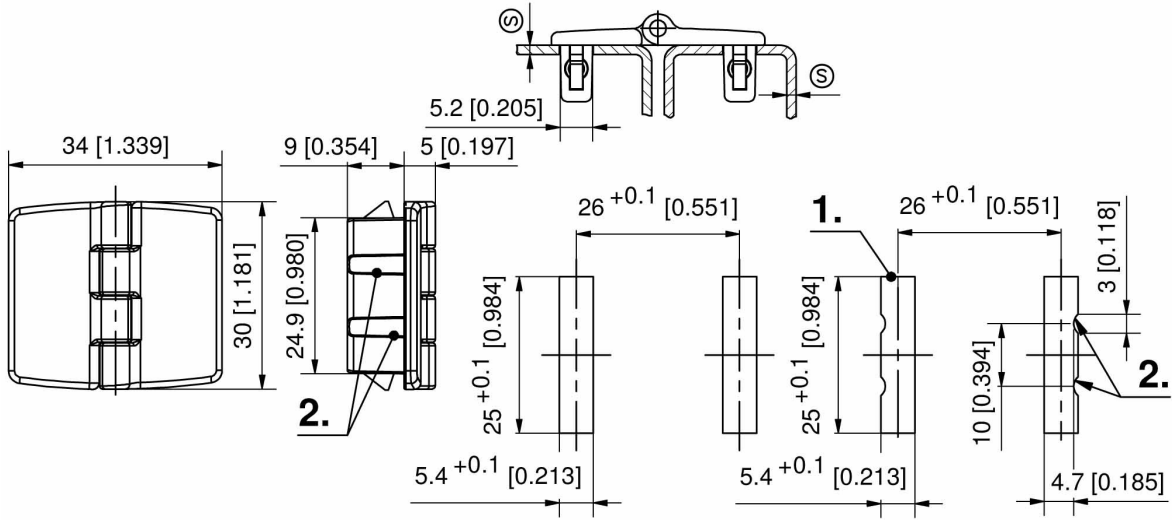



4-249.03DST DST Hinge 28x30 Pr01 180°



1DST1

Avantages

- Hinge with DIRAK-SNAP-Technology.
- For nested doors.
- Hinge visible.
- RH / LH application.
- 180° Opening angle.
- Tool-less installation by a simple push into the cutout.
- To guarantee a correct positional installation, the cutouts can have indentation.

Materials

- **Hinge-parts:** zinc die, matte chrome plated or black
- **Pin:** stainless steel
- **Snap wedges:** sintered steel, zinc plated

Notes

1. alternative cutout
2. indentation as a guideline for correct positional installation to avoid errors



Hinge, zinc die

Part Number	Clamping range (S)	Surface	Pin version	Installation type	Delivery Unit
418-9303.33-00008	0.6 - 0.9 mm	black	pressed in	tool-less	10 pcs.
418-9303.33-00010	0.8 - 1.1 mm	black	pressed in	tool-less	10 pcs.
418-9303.33-00014	1.2 - 1.5 mm	black	pressed in	tool-less	10 pcs.
418-9303.33-00020	1.8 - 2.1 mm	black	pressed in	tool-less	10 pcs.
418-9303.33-00024	2.2 - 2.5 mm	black	pressed in	tool-less	10 pcs.
418-9303.40-00008	0.6 - 0.9 mm	matte chrome plated	pressed in	tool-less	10 pcs.
418-9303.40-00010	0.8 - 1.1 mm	matte chrome plated	pressed in	tool-less	10 pcs.
418-9303.40-00014	1.2 - 1.5 mm	matte chrome plated	pressed in	tool-less	10 pcs.
418-9303.40-00020	1.8 - 2.1 mm	matte chrome plated	pressed in	tool-less	10 pcs.
418-9303.40-00024	2.2 - 2.5 mm	matte chrome plated	pressed in	tool-less	10 pcs.

