



4-345DST DST Hinge Pr01/04 180°



Avantages

- For nested or surface mounted doors.
- Hinge visible.
- With DIRAK-SNAP-Technology.
- RH and LH version.
- 180° Opening angle.
- Lift-off.
- Although designed initially for flush constructions, this hinge can also be used for surface mounted doors (refer to example of application 3.).
- The installation of the frame-part and door-part is tool-less, achieved by a simple push into the appropriate cutouts.
- Version with pressed in pin for high loads.

Materials

- **Hinge-parts:** zinc die, matt black
- **Pin cast-on:** zinc die
- **For heavy duty, solid pin, pressed in:** stainless steel
- **Spacer:** Teflon, black
- **Snap wedges:** sintered steel

Notes

Attention: The angle is only 130° for surface-mounted applications. See product system 4-346DST.

1. spacer
2. example of application nested door
3. example of application surface mounted door



Hinge

Part Number	Clamping range (S)	Version	Material pin	Pin version	Installation type	Delivery Unit
417-9005.00-00010	0.7 - 1.2 mm	RH version	zinc die	cast-on	tool-less	10 pcs.
417-9005.00-00015	1.2 - 1.7 mm	RH version	zinc die	cast-on	tool-less	10 pcs.
417-9005.00-00020	1.7 - 2.2 mm	RH version	zinc die	cast-on	tool-less	10 pcs.
417-9005.00-00030	2.7 - 3.2 mm	RH version	zinc die	cast-on	tool-less	10 pcs.
417-9011.00-00010	0.7 - 1.2 mm	RH version	stainless steel	pressed in	tool-less	10 pcs.
417-9011.00-00015	1.2 - 1.7 mm	RH version	stainless steel	pressed in	tool-less	10 pcs.
417-9011.00-00020	1.7 - 2.2 mm	RH version	stainless steel	pressed in	tool-less	10 pcs.
417-9011.00-00030	2.7 - 3.2 mm	RH version	stainless steel	pressed in	tool-less	10 pcs.
417-9006.00-00010	0.7 - 1.2 mm	LH version	zinc die	cast-on	tool-less	10 pcs.
417-9006.00-00015	1.2 - 1.7 mm	LH version	zinc die	cast-on	tool-less	10 pcs.
417-9006.00-00020	1.7 - 2.2 mm	LH version	zinc die	cast-on	tool-less	10 pcs.
417-9006.00-00030	2.7 - 3.2 mm	LH version	zinc die	cast-on	tool-less	10 pcs.
417-9010.00-00010	0.7 - 1.2 mm	LH version	stainless steel	pressed in	tool-less	10 pcs.
417-9010.00-00015	1.2 - 1.7 mm	LH version	stainless steel	pressed in	tool-less	10 pcs.
417-9010.00-00020	1.7 - 2.2 mm	LH version	stainless steel	pressed in	tool-less	10 pcs.
417-9010.00-00030	2.7 - 3.2 mm	LH version	stainless steel	pressed in	tool-less	10 pcs.

292-0306.80-02530 **Tool for uninstallation**

292-0401.00-03010 **Cutout-cover**

292-0702.15-01030 **Reinforcement plate for cutout**

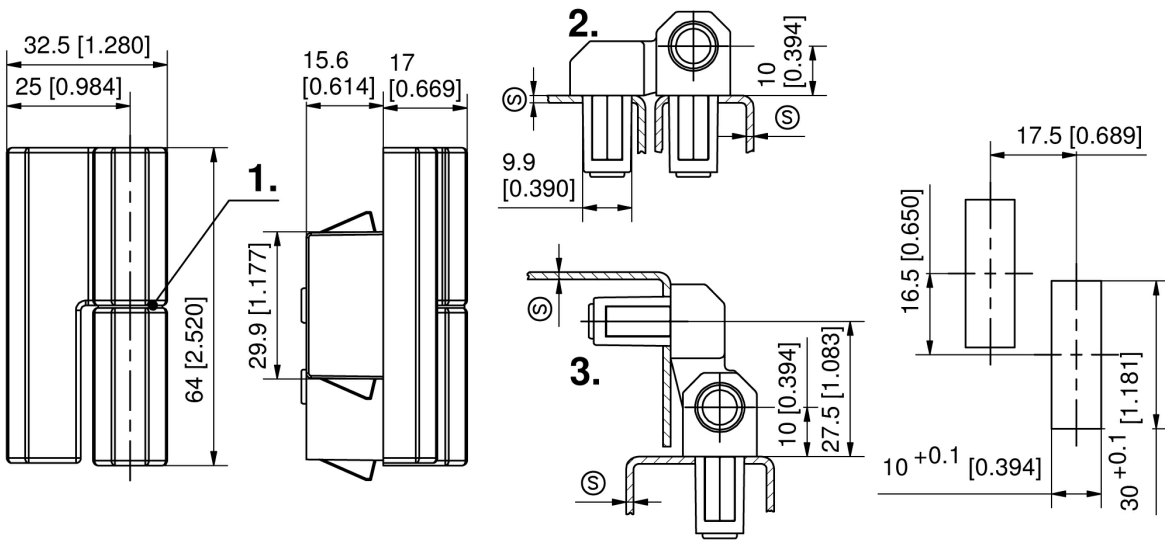



4-346DST DST Hinge Pr01 160°



Avantages

- For nested doors.
- Hinge visible.
- RH and LH version.
- 160° Opening angle.
- With DIRAK-SNAP-Technology.
- Lift-off.
- The installation of the frame-part and door-part is tool-less, achieved by a simple push into the appropriate cutouts.

Materials

- **Hinge-parts:** zinc die, matte black
- **Solid pin, pressed in:** stainless steel
- **Spacer:** Teflon, black
- **Snap wedges:** sintered steel

Notes

1. spacer



Hinge

Part Number	Clamping range (S)	Version	Pin version	Installation type	Delivery Unit
417-9007.00-00010	0.7 - 1.2 mm	RH version	pressed in	tool-less	10 pcs.
417-9007.00-00015	1.2 - 1.7 mm	RH version	pressed in	tool-less	10 pcs.
417-9007.00-00020	1.7 - 2.2 mm	RH version	pressed in	tool-less	10 pcs.
417-9007.00-00030	2.7 - 3.2 mm	RH version	pressed in	tool-less	10 pcs.
417-9008.00-00010	0.7 - 1.2 mm	LH version	pressed in	tool-less	10 pcs.
417-9008.00-00015	1.2 - 1.7 mm	LH version	pressed in	tool-less	10 pcs.
417-9008.00-00020	1.7 - 2.2 mm	LH version	pressed in	tool-less	10 pcs.
417-9008.00-00030	2.7 - 3.2 mm	LH version	pressed in	tool-less	10 pcs.



292-0306.80-02530 **Tool for uninstallation**

292-0401.00-03010 **Cutout-cover**

292-0702.15-01030 **Reinforcement plate for cutout**

